

Reference Guide

Repatha® (ri-Path-a) (evolocumab)
Single-Use Prefilled SureClick® Autoinjector

Read all instructions in carton before use.

Questions? Call 1-844-REPATHA (1-844-737-2842)

Guide to parts

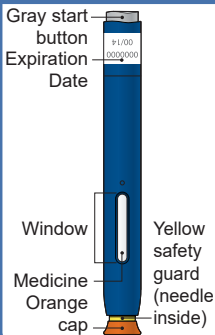

Wait at least 30 minutes for the autoinjector to come to room temperature before giving your injection.

Prepare and clean your injection site.

1

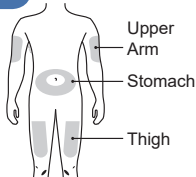

Pull the orange cap off only when you are ready to inject. **Do not** leave the orange cap off for more than **5 minutes**. This can dry out the medicine.

2

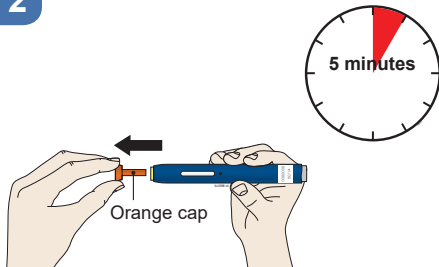

Stretch or pinch your injection site to create a firm surface.

3

Stretch method:



or

Pinch method:



Put the yellow safety guard (needle inside) on your skin at 90 degrees.

4

Yellow safety guard (needle inside)

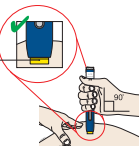

Firmly push down the autoinjector onto your skin until it stops moving.

5

When you are ready to inject, **press** the gray start button. You will hear a click.

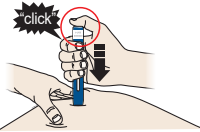

Keep **pushing** down on your skin for about 15 seconds.

6



Window turns from clear to yellow when the injection is done.

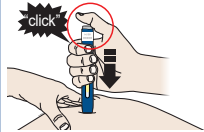

AMGEN®

Manufactured by:
Amgen Inc.
Thousand Oaks, CA 91320-1799
© 2019 Amgen Inc.
All rights reserved.
TS00859 Revised: 09/2019 v2
USA-145-81661